

**NOTICE!!**

**These documents have been scanned!**

**Do not place un-scanned documents beneath this notice!**

**Do not remove this notice from this file!**

GPO Jacket No. 560-102  
Print Order 61540  
Rise Business Services, LLC  
Job=AZ15 5/2/2019



Box Number= AZ15016



Claim Begin-End: AMC438787-AMC438787

1 Initial Receipt



AZ15016-20

AMC438349-AMC438982





**United States Department of the Interior**  
**Bureau of Land Management**  
 DIV OF LANDS, MINRLS & ENERGY  
 ONE N CENTRAL AVE  
 PHOENIX, AZ 85004 -4427  
 Phone: 602-417-9200

Receipt

No: 3600251

|  |   |
|--|---|
| <b>Transaction #:</b> 3703603          |   |
| <b>Date of Transaction:</b> 07/06/2016 |   |
| CUSTOMER:                              |   |
|  | BRENT A PAUL<br>2136 HORSEMINT AVE<br>KINGMAN, AZ 86401-5583 US |

ENTERED  
 JUL 15 2016  
 BY: RAM

| LINE #        | QTY  | DESCRIPTION   | REMARKS | UNIT PRICE | TOTAL           |
|---------------|------|---|---------|------------|-----------------|
| 1             | 1.00 | LOCATABLE MINERALS / MINING CLAIMS-NEW, UNADJUD, ONE OR MORE AUTH NOS / NEW MINING CLAIM PROCESSING FEE<br><b>CASES: AMC438787/\$20.00</b>    |         | - n/a -    | 20.00           |
| 2             | 1.00 | LOCATABLE MINERALS / MINING CLAIMS-NEW, UNADJUD, ONE OR MORE AUTH NOS / NEW MINING CLAIMS LOCATION FEE<br><b>CASES: AMC438787/\$37.00</b>     |         | - n/a -    | 37.00           |
| 3             | 1.00 | LOCATABLE MINERALS / MINING CLAIMS-NEW, UNADJUD, ONE OR MORE AUTH NOS / NEW MINING CLAIMS MAINTENANCE FEE<br><b>CASES: AMC438787/\$155.00</b> |         | - n/a -    | 155.00          |
| <b>TOTAL:</b> |      |   |         |            | <b>\$212.00</b> |

| PAYMENT INFORMATION |           |   |                        |
|---------------------|-----------|---|------------------------|
| 1                   | AMOUNT:   | 212.00  | POSTMARKED: 07/01/2016 |
|                     | TYPE:     | CHECK   | RECEIVED: 07/05/2016   |
|                     | CHECK NO: | 1271  |                        |
|                     | NAME:     | PAUL, BRENT A<br>2136 HORSEMINT AVE<br>KINGMAN AZ 86401-5583 US |                        |

|         |
|---------|
| REMARKS |
|         |

This receipt was generated by the automated BLM Collections and Billing System and is a paper representation of a portion of the official electronic record contained therein.



**NOTICE!!**

**These documents have been scanned!**

**Do not place un-scanned documents beneath this notice!**

**Do not remove this notice from this file!**

GPO Jacket No. 560-102  
Print Order 61540  
Rise Business Services, LLC  
Job=AZ15 5/2/2019



Box Number= AZ15016



Claim Begin-End: AMC438787-AMC438787

2 Correspondence



AZ15016-20

AMC438349-AMC438982



**NO  
DOCUMENTS  
FOUND**

NO DOCUMENTS FOUND  
NO DOCUMENTS FOUND



**NOTICE!!**

**These documents have been scanned!**

**Do not place un-scanned documents beneath this notice!**

**Do not remove this notice from this file!**

GPO Jacket No. 560-102  
Print Order 61540  
Rise Business Services, LLC  
Job=AZ15 5/2/2019



Box Number= AZ15016



Claim Begin-End: AMC438787-AMC438787

3 Transfers



AZ15016-20

AMC438349-AMC438982



**NO  
DOCUMENTS  
FOUND**

NO DOCUMENTS FOUND  
NO DOCUMENTS FOUND



**NOTICE!!**

**These documents have been scanned!**

**Do not place un-scanned documents beneath this notice!**

**Do not remove this notice from this file!**

GPO Jacket No. 560-102  
Print Order 61540  
Rise Business Services, LLC  
Job=AZ15 5/2/2019



Box Number= AZ15016



Claim Begin-End: AMC438787-AMC438787

4 Annual Filings



AZ15016-20

AMC438349-AMC438982



DEPARTMENT OF THE INTERIOR  
BUREAU OF LAND MANAGEMENT  
MINING CLAIMS

Run Date/Time: 9/11/2018

MC Maintenance Fees Paid Through the BLM Pay Portal  
(by Date Paid)

Page 306 Of 723

**CBS Receipt: 4246779**

Agency Tracking ID: 1535391218

Assessment Year: 2019

Paid On: 8/27/2018

Printed For Lead File # AMC438787

Number of BLM Serial Nr: 2

Total Amount Paid: \$310.00

| Claim Name | BLM Serial No | Lead File No | Amount Paid |
|------------|---------------|--------------|-------------|
| TRIPLE B   | AMC438787     | AMC438787    | \$155.00    |
| TRIPLE B2  | AMC439773     | AMC439773    | \$155.00    |



**United States Department of the Interior**  
**Bureau of Land Management**  
 BUSINESS & SUPPORT SVCS DIV  
 ONE N CENTRAL AVE SUITE 800  
 PHOENIX, AZ 85004 -4427  
 Phone: 602-417-9200

Receipt

No: 4246779

|  |  |
|--|--|
| <b>Transaction #:</b> 4362242                        |  |
| <b>Date of Transaction:</b> 08/27/2018               |  |
| <b>CUSTOMER:</b>                                     |  |
| BRENT PAUL<br>196 N 2825 W<br>CEDAR CITY,UT 86401 US |  |

| LINE #        | QTY  | DESCRIPTION  | REMARKS | UNIT PRICE | TOTAL           |
|---------------|------|--|---------|------------|-----------------|
| 1             | 1.00 | LOCATABLE MINERALS / MINING CLAIMS-NOT NEW-UNADJUD,ONE AUTH NO. ONLY / MINING CLAIM MONEY RECEIVED<br><b>CASES: AMC438787/\$310.00</b> |         | - n/a -    | 310.00          |
| <b>TOTAL:</b> |      |  |         |            | <b>\$310.00</b> |

| PAYMENT INFORMATION   |               |  |             |            |  |
|---|---------------|--|-------------|------------|--|
| NOTE: Items will appear on credit card statement as "BLM O Mining Claim". |               |  |             |            |  |
| 1   | AMOUNT:       | 310.00   | POSTMARKED: | N/A        |  |
|   | TYPE:         | CREDIT CARD  | RECEIVED:   | 08/27/2018 |  |
|   | NAME:         | BRENT PAUL<br>196 N 2825 W<br>CEDAR CITY UT 86401 US |             |            |  |
|   | CARD NO:      | XXXXXXXXXXXX1208                                     | AUTH CODE:  | 05741C     |  |
|   | NAME ON CARD: | BRENT PAUL   |             |            |  |
|   | SIGNATURE:    |  |             |            |  |

|         |
|---------|
| REMARKS |
|         |

This receipt was generated by the automated BLM Collections and Billing System and is a paper representation of a portion of the official electronic record contained therein.

Run Date: 08/28/17

Run Time: 12:44 PM

**DEPARTMENT OF THE INTERIOR  
BUREAU OF LAND MANAGEMENT  
MINING CLAIMS**

**MC Maintenance Fees Paid Through the BLM Pay Portal**

**CBS Receipt: 3951266**

Printed For Lead File # AMC438787

Agency Tracking ID: 1503432863

Assessment Year: 2018

Number of BLM Serial Nr: 6

Paid On: 08/22/2017

Total Amount Paid: \$930.00

| Claim Name  | BLM Serial No | Lead File No | Amount Paid |
|-------------|---------------|--------------|-------------|
| TRIPLE B    | AMC438787     | AMC438787    | \$155.00    |
| TRIPLE B2   | AMC439773     | AMC439773    | \$155.00    |
| TRIPLE B3   | AMC439774     | AMC439773    | \$155.00    |
| TRIPLE B4   | AMC439775     | AMC439773    | \$155.00    |
| TRIPLE B #5 | AMC440421     | AMC440421    | \$155.00    |
| TRIPLE B #6 | AMC440422     | AMC440421    | \$155.00    |



**United States Department of the Interior**  
**Bureau of Land Management**  
 BUSINESS & SUPPORT SVCS DIV  
 ONE N CENTRAL AVE SUITE 800  
 PHOENIX, AZ 85004 -4427  
 Phone: 602-417-9200

Receipt

No: 3951266

|   |  |
|---|--|
| <b>Transaction #:</b> 4060995                               |  |
| <b>Date of Transaction:</b> 08/22/2017                      |  |
| CUSTOMER:   |  |
| BRENT A. PAUL<br>2136 HORSEMINT AVE<br>KINGMAN, AZ 86401 US |  |

| LINE #        | QTY  | DESCRIPTION  | REMARKS | UNIT PRICE | TOTAL           |
|---------------|------|--|---------|------------|-----------------|
| 1             | 1.00 | LOCATABLE MINERALS / MINING CLAIMS- NOT NEW-UNADJUD, ONE AUTH NO. ONLY / MINING CLAIM MONEY RECEIVED<br><b>CASES: AMC440422/\$930.00</b> |         | - n/a -    | 930.00          |
| <b>TOTAL:</b> |      |  |         |            | <b>\$930.00</b> |

| PAYMENT INFORMATION   |               |  |             |            |
|---|---------------|--|-------------|------------|
| NOTE: Items will appear on credit card statement as "BLM O Mining Claim". |               |  |             |            |
| 1   | AMOUNT:       | 930.00   | POSTMARKED: | N/A        |
|   | TYPE:         | CREDIT CARD  | RECEIVED:   | 08/22/2017 |
|   | NAME:         | BRENT A. PAUL<br>2136 HORSEMINT AVE<br>KINGMAN AZ 86401 US |             |            |
|   | CARD NO:      | XXXXXXXXXXXX1208   | AUTH CODE:  | 08352C     |
|   | NAME ON CARD: | BRENT A. PAUL  |             |            |
|   | EXPIRES:      | 12/2019  |             |            |
|   | SIGNATURE:    |  |             |            |

|         |
|---------|
| REMARKS |
|         |

This receipt was generated by the automated BLM Collections and Billing System and is a paper representation of a portion of the official electronic record contained therein.

Run Date: 08/25/16

Run Time: 05:50 AM

**DEPARTMENT OF THE INTERIOR  
BUREAU OF LAND MANAGEMENT  
MINING CLAIMS**

**MC Maintenance Fees Paid Through the BLM Pay Portal**

**CBS Receipt: 3628511**

Printed For Lead File # **AMC438787**

Agency Tracking ID: 1470949247

Assessment Year: 2017

Number of BLM Serial Nr: 1

Paid On: 08/11/2016

Total Amount Paid: \$155.00

| Claim Name | BLM Serial No | Lead File No | Amount Paid |
|------------|---------------|--------------|-------------|
| TRIPLE B   | AMC438787     | AMC438787    | \$155.00    |



**United States Department of the Interior**  
**Bureau of Land Management**  
 BUSINESS & SUPPORT SVCS DIV  
 ONE N CENTRAL AVE SUITE 800  
 PHOENIX, AZ 85004 -4427  
 Phone: (602) 417-9200

Receipt

No: 3628511

|   |  |
|---|--|
| <b>Transaction #:</b> 3732275                           |  |
| <b>Date of Transaction:</b> 08/11/2016                  |  |
| <b>CUSTOMER:</b>  |  |
| BRENT PAUL<br>2136 HORSEMNT AVE<br>KINGMAN, AZ 86401 US |  |

| LINE #        | QTY  | DESCRIPTION  | REMARKS | UNIT PRICE | TOTAL           |
|---------------|------|--|---------|------------|-----------------|
| 1             | 1.00 | LOCATABLE MINERALS / MINING CLAIMS- NOT NEW-UNADJUD, ONE AUTH NO. ONLY / MINING CLAIM MONEY RECEIVED<br><b>CASES: AMC438787/\$155.00</b> |         | - n/a -    | 155.00          |
| <b>TOTAL:</b> |      |  |         |            | <b>\$155.00</b> |

| PAYMENT INFORMATION   |               |  |                      |
|---|---------------|--|----------------------|
| NOTE: Items will appear on credit card statement as "BLM O Mining Claim". |               |  |                      |
| 1   | AMOUNT:       | 155.00   | POSTMARKED: N/A      |
|   | TYPE:         | CREDIT CARD  | RECEIVED: 08/11/2016 |
|   | NAME:         | BRENT PAUL<br>2136 HORSEMNT AVE<br>KINGMAN AZ 86401 US |                      |
|   | CARD NO:      | XXXXXXXXXXXX6833                                       | AUTH CODE: 040317    |
|   | NAME ON CARD: | BRENT PAUL   |                      |
|   | EXPIRES:      | 10/2018  |                      |
|   | SIGNATURE:    |  |                      |

| REMARKS |
|---------|
|         |

This receipt was generated by the automated BLM Collections and Billing System and is a paper representation of a portion of the official electronic record contained therein.



**NOTICE!!**

**These documents have been scanned!**

**Do not place un-scanned documents beneath this notice!**

**Do not remove this notice from this file!**

GPO Jacket No. 560-102  
Print Order 61540  
Rise Business Services, LLC  
Job=AZ15 5/2/2019



Box Number= AZ15016



Claim Begin-End: AMC438787-AMC438787

5 Miscellaneous



AZ15016-20

AMC438349-AMC438982



**NO  
DOCUMENTS  
FOUND**

NO DOCUMENTS FOUND  
NO DOCUMENTS FOUND



**NOTICE!!**

**These documents have been scanned!**

**Do not place un-scanned documents beneath this notice!**

**Do not remove this notice from this file!**

GPO Jacket No. 560-102  
Print Order 61540  
Rise Business Services, LLC  
Job=AZ15 5/2/2019



Box Number= AZ15016



Claim Begin-End: AMC438787-AMC438787

6 Location Notices-Amendments and Supporting Documents



AZ15016-20

AMC438349-AMC438982







# MINING CLAIM STATUS REPORT

Data Entered: 07/15/16

MTP Checked By: 07/15/16

GEO Checked By: 07/15/16

LEAD SERIAL NUMBER: AMC 438787 thru AMC \_\_\_\_\_

**NUMBER OF CLAIMS & TYPE:**

- 1 LODE
- \_\_\_\_\_ PLACER
- \_\_\_\_\_ ASSOCIATION PLACER
- \_\_\_\_\_ MILL SITE
- \_\_\_\_\_ TUNNEL SITE

**CHARGES:**

|                                    |    |            |
|------------------------------------|----|------------|
| Location Fee @ \$37 =              | \$ | <u>37</u>  |
| Processing Fee @ \$20 =            | \$ | <u>20</u>  |
| Maintenance Fee @ \$155 =          | \$ | <u>155</u> |
| Add'l Maint Fee for Assoc Placer = | \$ |            |
| <b>SUBTOTAL</b>                    | \$ |            |
| Other Fees                         | \$ |            |
| Other Fees                         | \$ |            |
| <b>TOTAL</b>                       | \$ | <u>212</u> |

TOTAL ACREAGE: \_\_\_\_\_ Per Claim  
(Placer Only)

NUMBER OF LOCATORS: \_\_\_\_\_

DOCUMENTS RECEIVED VIA: Over-the-Counter [ ] Mail [] TIMELY FILED: Yes [] No [ ]

LEGAL DESCRIPTION:

|   |            |   |            |     |           |
|---|------------|---|------------|-----|-----------|
| T | <u>17N</u> | R | <u>11W</u> | SEC | <u>30</u> |
| T | _____      | R | _____      | SEC | _____     |
| T | _____      | R | _____      | SEC | _____     |
| T | _____      | R | _____      | SEC | _____     |
| T | _____      | R | _____      | SEC | _____     |

BLM [ ] FOREST SERVICE [ ] WILDERNESS AREA [ ] SUBJ TO PL 359: Yes [ ] No [ ]

SPLIT ESTATE: N/A [ ] SX [ ] PX [ ] OTHER [ ]  
SRHA [ ] Was proper Notice filed if located on SHRA Land? Yes [ ] No [ ]

RECONVEYED MINERALS ON BLM LAND REQUIRE OPENING ORDER FROM 1944 TO 1993:  
Open to Entry On \_\_\_\_\_ N/A [ ]

COMMENTS/STATUS: VOID [ ] PARTIALLY VOID [ ] PVT MINERALS [ ] WITHDRAWN LANDS [ ]  
OTHER [ ] \_\_\_\_\_

No mib but claim is in corner - No Angles  
A 22407 10/24/86 State Exchange. Open to mining.

[ ] Claimant acknowledges that portions of the following claim(s) site(s) may be void or voidable.

Printed Name of Claimant \_\_\_\_\_ Signature of Claimant \_\_\_\_\_

\*\*\*\*\*FINAL ADJUDICATION\*\*\*\*\*

DATE 2/6/17 INITIALS AT

AMC438787



LOCATION NOTICE FOR LODGE MINING CLAIM

Amendment BLM Serial # \_\_\_\_\_

NOTICE IS HEREBY GIVEN that the Triple B

\_\_\_\_\_ lode mining claim has been located

by Brent A. Paul whose current mailing

address is 2136 Horsemint Ave  
Kingman, AZ 86401

RECEIVED  
BLM AT STATE OFFICE  
2016 JUL -5 P 3:30  
PHOENIX, ARIZONA  
BLM  
Date  
Stamp

The general course of this claim is West to East and it is situated in Mohave  
County, Arizona. This claim is 1500 feet in length and 600 feet in width.

\_\_\_\_\_ Total Claim Acreage. This claim runs from the location monument on which this location notice is posted on the centerline of the claim approximately 750 feet in a Westerly direction to the West end line and 750 feet in a Easterly direction to the East end line. This claim is marked by six monuments, one at each corner and one at the center of each end line of the claim.

The location monument on which this notice is posted is situated within Section 30, Township 17N, Range 11W, Gila Salt River Base and Meridian, Arizona and this claim encompasses portions

of the following quarter section(s), section(s), Township(s) and Range(s) Quarter Quarter section: L- Section: 30 Township 17N Range 11W  
Gila Salt River Base and Meridian, Arizona.

The locality of this claim with reference to some natural object or permanent monument and additional information

(if any) concerning its locality are as follows: 11.2 miles North East of Wikieup, AZ. 1.7 miles East of Old Mulberry Camp, Bogle Ranch

The above information is shown on the attached map.

DATED AND POSTED on the ground this 23<sup>rd</sup> day of June, 2016.

LOCATOR(s)  AGENT

Print Name(s) Brent A. Paul

Signature(s) Brent A. Paul

AMC438787

**MINING CLAIM MAP**

Lode (X) Placer ( )  
Millsite ( )

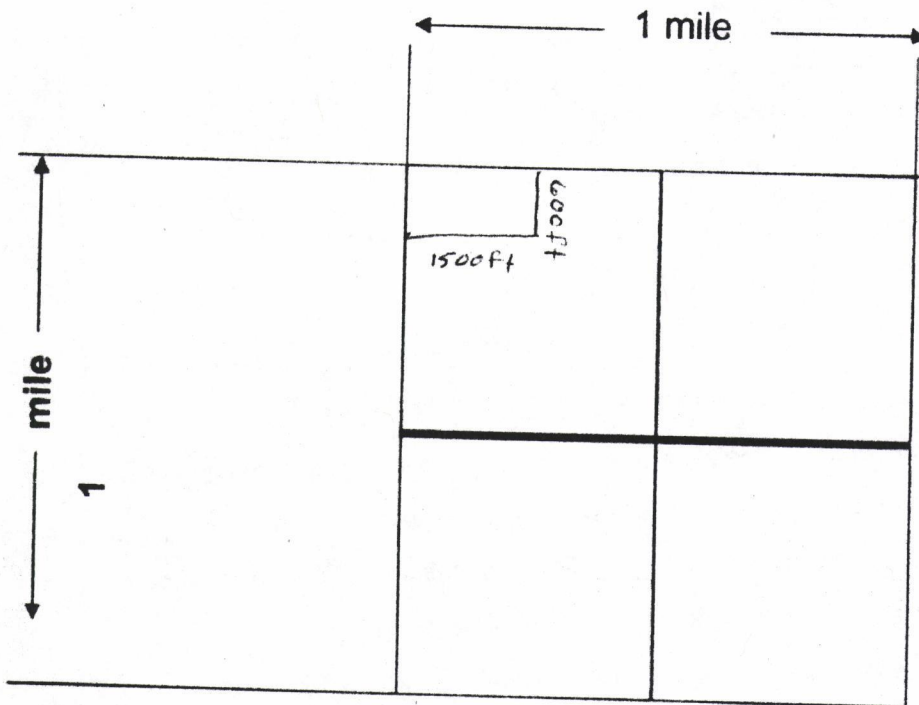

RECEIVED  
BLM AZ STATE OFFICE  
2016 JUL -5 P 3:30  
PHOENIX, ARIZONA

Scale: 1" = 2000 feet



1. The above map depicts the Triple B mining claim, which is located in Section (s) 30, Township 17N, Range 11W, Gila and Salt River Base and Meridian, Mohave County, Arizona. Total claim acreage is 600 x 1500 ft.
2. The type of corner and location monuments used are as follows: PVC pipe
3. The bearings and distances in degrees and feet between claim corners and to a public land survey monument are as depicted on the map.
4. If the claim is a placer or millsite claim with exterior limits conforming to legal subdivisions of the public survey, provide a legal description of the claim N/A

ANC438787

Locator: Brent A. Paul  
*Brent A. Paul*

Form MCF100a  
Revised July 2014

This form is available from the Arizona Geology Survey and may be reproduced.



**BUREAU OF LAND MANAGEMENT  
CASE RECORDATION  
(LIVE) SERIAL REGISTER PAGE**

Run Date/Time: 02/06/17 06:08 PM

Page 1 of 2

01 10-21-1976;090STAT2756;43USC1716

Total Acres

Serial Number

Case Type 221006: EX-STATE SEC 206, FLPMA

18,113.970

AZA--- - 022407PT

Commodity 001: NONE

Case Disposition: AUTHORIZED Case File Juris:

Serial Number: AZA--- - 022407PT

| Name & Address | Int Rel                 | %Interest            |
|----------------|-------------------------|----------------------|
| BLM AZ SO      | 1 N CENTRAL AVE STE 800 | PHOENIX AZ 850044427 |
|                | ADMIN MGT ENTITY        | 100.000000000        |

|         |       |       |       |         |                  |                        | Serial Number: AZA--- - 022407PT |                     |  |
|---------|-------|-------|-------|---------|------------------|------------------------|----------------------------------|---------------------|--|
| Mer Twp | Rng   | Sec   | SType | Nr Suff | Subdivision      | District/Resource Area | County                           | Mgmt Agency         |  |
| 14      | 0150N | 0100W | 016   | ALIQ    | N2;              | KINGMAN FO             | YAVAPAI                          | BUREAU OF LAND MGMT |  |
| 14      | 0160N | 0100W | 002   | ALIQ    | S2N2,S2;         | KINGMAN FO             | YAVAPAI                          | BUREAU OF LAND MGMT |  |
| 14      | 0160N | 0100W | 002   | LOTS    | 1-4;             | KINGMAN FO             | YAVAPAI                          | BUREAU OF LAND MGMT |  |
| 14      | 0160N | 0100W | 004   | ALIQ    | S2N2,S2;         | KINGMAN FO             | YAVAPAI                          | BUREAU OF LAND MGMT |  |
| 14      | 0160N | 0100W | 004   | LOTS    | 1-4;             | KINGMAN FO             | YAVAPAI                          | BUREAU OF LAND MGMT |  |
| 14      | 0160N | 0100W | 006   | ALIQ    | S2NE,E2SW,SE;    | KINGMAN FO             | MOHAVE                           | BUREAU OF LAND MGMT |  |
| 14      | 0160N | 0100W | 006   | LOTS    | 1-7;             | KINGMAN FO             | MOHAVE                           | BUREAU OF LAND MGMT |  |
| 14      | 0160N | 0100W | 008   | ALIQ    | ALL;             | KINGMAN FO             | MOHAVE                           | BUREAU OF LAND MGMT |  |
| 14      | 0160N | 0100W | 008   | ALIQ    | ALL;             | KINGMAN FO             | YAVAPAI                          | BUREAU OF LAND MGMT |  |
| 14      | 0160N | 0100W | 016   | ALIQ    | ALL;             | KINGMAN FO             | YAVAPAI                          | BUREAU OF LAND MGMT |  |
| 14      | 0160N | 0100W | 018   | ALIQ    | E2W2,E2;         | KINGMAN FO             | MOHAVE                           | BUREAU OF LAND MGMT |  |
| 14      | 0160N | 0100W | 018   | LOTS    | 1-4;             | KINGMAN FO             | MOHAVE                           | BUREAU OF LAND MGMT |  |
| 14      | 0160N | 0100W | 032   | ALIQ    | ALL;             | KINGMAN FO             | YAVAPAI                          | BUREAU OF LAND MGMT |  |
| 14      | 0160N | 0100W | 032   | ALIQ    | ALL;             | KINGMAN FO             | MOHAVE                           | BUREAU OF LAND MGMT |  |
| 14      | 0162N | 0100W | 032   | ALIQ    | ALL;             | KINGMAN FO             | MOHAVE                           | BUREAU OF LAND MGMT |  |
| 14      | 0162N | 0100W | 032   | ALIQ    | ALL;             | KINGMAN FO             | YAVAPAI                          | BUREAU OF LAND MGMT |  |
| 14      | 0160N | 0110W | 002   | ALIQ    | S2N2,S2;         | KINGMAN FO             | MOHAVE                           | BUREAU OF LAND MGMT |  |
| 14      | 0160N | 0110W | 002   | LOTS    | 1-4;             | KINGMAN FO             | MOHAVE                           | BUREAU OF LAND MGMT |  |
| 14      | 0160N | 0110W | 016   | ALIQ    | ALL;             | KINGMAN FO             | MOHAVE                           | BUREAU OF LAND MGMT |  |
| 14      | 0160N | 0110W | 032   | ALIQ    | ALL;             | KINGMAN FO             | MOHAVE                           | BUREAU OF LAND MGMT |  |
| 14      | 0160N | 0110W | 036   | ALIQ    | NE,W2,N2SE,SWSE; | KINGMAN FO             | MOHAVE                           | BUREAU OF LAND MGMT |  |
| 14      | 0160N | 0110W | 036   | LOTS    | 1;               | KINGMAN FO             | MOHAVE                           | BUREAU OF LAND MGMT |  |
| 14      | 0162N | 0110W | 032   | ALIQ    | ALL;             | KINGMAN FO             | MOHAVE                           | BUREAU OF LAND MGMT |  |
| 14      | 0170N | 0110W | 016   | ALIQ    | ALL;             | KINGMAN FO             | MOHAVE                           | BUREAU OF LAND MGMT |  |
| 14      | 0170N | 0110W | 018   | ALIQ    | E2W2,E2;         | KINGMAN FO             | MOHAVE                           | BUREAU OF LAND MGMT |  |
| 14      | 0170N | 0110W | 018   | LOTS    | 1-4;             | KINGMAN FO             | MOHAVE                           | BUREAU OF LAND MGMT |  |
| 14      | 0170N | 0110W | 020   | ALIQ    | ALL;             | KINGMAN FO             | MOHAVE                           | BUREAU OF LAND MGMT |  |
| 14      | 0170N | 0110W | 028   | ALIQ    | ALL;             | KINGMAN FO             | MOHAVE                           | BUREAU OF LAND MGMT |  |
| 14      | 0170N | 0110W | 030   | ALIQ    | E2W2,E2;         | KINGMAN FO             | MOHAVE                           | BUREAU OF LAND MGMT |  |
| 14      | 0170N | 0110W | 030   | LOTS    | 1-4;             | KINGMAN FO             | MOHAVE                           | BUREAU OF LAND MGMT |  |
| 14      | 0170N | 0110W | 032   | ALIQ    | ALL;             | KINGMAN FO             | MOHAVE                           | BUREAU OF LAND MGMT |  |
| 14      | 0160N | 0120W | 002   | ALIQ    | S2N2,S2;         | KINGMAN FO             | MOHAVE                           | BUREAU OF LAND MGMT |  |
| 14      | 0160N | 0120W | 002   | LOTS    | 1-4;             | KINGMAN FO             | MOHAVE                           | BUREAU OF LAND MGMT |  |
| 14      | 0160N | 0120W | 016   | ALIQ    | ALL;             | KINGMAN FO             | MOHAVE                           | BUREAU OF LAND MGMT |  |
| 14      | 0160N | 0120W | 032   | ALIQ    | ALL;             | KINGMAN FO             | MOHAVE                           | BUREAU OF LAND MGMT |  |
| 14      | 0160N | 0120W | 036   | ALIQ    | ALL;             | KINGMAN FO             | MOHAVE                           | BUREAU OF LAND MGMT |  |
| 14      | 0162N | 0120W | 036   | ALIQ    | ALL;             | KINGMAN FO             | MOHAVE                           | BUREAU OF LAND MGMT |  |
| 14      | 0170N | 0120W | 014   | ALIQ    | ALL;             | KINGMAN FO             | MOHAVE                           | BUREAU OF LAND MGMT |  |
| 14      | 0170N | 0120W | 024   | ALIQ    | ALL;             | KINGMAN FO             | MOHAVE                           | BUREAU OF LAND MGMT |  |
| 14      | 0170N | 0120W | 026   | ALIQ    | ALL;             | KINGMAN FO             | MOHAVE                           | BUREAU OF LAND MGMT |  |
| 14      | 0170N | 0120W | 036   | ALIQ    | ALL;             | KINGMAN FO             | MOHAVE                           | BUREAU OF LAND MGMT |  |

Serial Number: AZA--- - 022407PT

| Act Date | Code | Action | Action Remarks | Pending Office |
|----------|------|--------|----------------|----------------|
|----------|------|--------|----------------|----------------|



**BUREAU OF LAND MANAGEMENT  
CASE RECORDATION  
(LIVE) SERIAL REGISTER PAGE**

Run Date/Time: 02/06/17 06:08 PM

Page 2 of 2

|            |     |                      |                       |
|------------|-----|----------------------|-----------------------|
| 09/30/1986 | 387 | CASE ESTABLISHED     |                       |
| 10/16/1986 | 910 | REPORT REQUESTED     | APPRAISALS            |
| 10/17/1986 | 911 | REPORT RECEIVED      | APPRAISALS            |
| 10/24/1986 | 393 | DEC ISSUED           | RECON ACCPT-PAT ISSUE |
| 10/24/1986 | 865 | TITLE ACCEPTED BY US |                       |
| 12/02/1986 | 103 | ADDTL INFO RECD      | MEMO TO DO W/ENCL     |
| 01/01/1987 | 042 | CASE SENT TO         | PAPER CY-DRAFT        |
| 01/02/1987 | 610 | PUBLISHED            | 52FR171;              |
| 02/05/1987 | 873 | OPEN TO ENTRY        |                       |
| 11/03/1987 | 393 | DEC ISSUED           | CORRECT PREVIOUS DEC  |
| 11/05/1987 | 042 | CASE SENT TO         | RECORDS               |
| 11/05/1987 | 149 | CASE RECEIVED FROM   |                       |
| 02/04/1988 | 600 | RECORDS NOTED        |                       |

Line Nr      Remarks      Serial Number: AZA--- - 022407PT

|      |   |
|------|---|
| 0001 | STATE DEED OF RECONVEYANCE 96-93823.                |
| 0002 | 10/16/1986 SHOULD THE DIFFERENCE IN APPRAISALS FOR  |
| 0003 | THE BASE & SELECTED LANDS BE EQUALIZED              |
| 0004 | 10/17/1986 THE DIFFERENCE SHOULD BE TRACKED         |
| 0005 | AT 9:00AM ON 2/5/87-THE LANDS WILL BE OPEN TO ENTRY |
| 0006 | UNDER THE PUBLIC LAND LAWS, INCLUDING THE GENERAL   |
| 0007 | MINING LAWS AND MINERAL LEASING LAWS.      SD       |



Input Parameters for Geographic Report with Land

System Id = CR

Admin State = AZ

Geo State =

Casetype Begins With

Case Disp Txt = AUTHORIZED, CANCELLED, EXPIRED, PENDING, REJECTED, RELINQUISHED, WITHDRAWN

Mer Twp Rng =

Section =

Mtrs = 14 0170N 0110W 030, 14 0170N 0110W 999

Commodity =

Commodity Txt =

Pending Org =

Pend Org Decode =

Total Rows Returned: 2

RUN TIME: 08:57 AM

UNITED STATES DEPARTMENT OF INTERIOR  
BUREAU OF LAND MANAGEMENT  
GEOGRAPHIC REPORT WITH LAND  
Sorted by Serial Number

RUN DATE: 07/15/2016  
Page 1 of 1

Adm State: AZ

Serial Number: AZA 022407PT  
Total Case Acres: 18,113.970

| <u>Casetype</u> | <u>Case Disp</u> |    |       |       | <u>Sect</u> | <u>Sur Typ</u> | <u>Sur Num</u> | <u>Suff</u> | <u>Subdivision</u> | <u>Act Pend</u> |
|-----------------|------------------|----|-------|-------|-------------|----------------|----------------|-------------|--------------------|-----------------|
| 221006          | AUTHORIZED       | 14 | 0170N | 0110W | 030         | ALIQ<br>LOTS   |                |             | E2W2,E2;<br>1-4;   |                 |





Brent A. Paul  
2136 Horsemint Ave  
Kingman, AZ 86401

RECEIVED  
BLM ARIZONA STATE OFFICE  
2016 JUL - 5 P 3:27  
PHOENIX, ARIZONA



Bureau of Land Management

Arizona State Office

One North Central Ave. Suite: 800

Phoenix, AZ 85004-4427

950044427 0041

